

# Product Sheet

18.06.2026

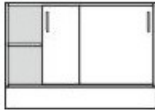

<b>Model series</b>	Armadio-Base
<b>Description</b>	Sliding door cupboard
<b>Model</b>	81200
<b>ID</b>	57803
<b>Width/Depth/Height</b>	105/43/73.5 cm
<b>Weight</b>	40.5 kg

2 sliding doors with metal bow handle and drilled stop damping.

**Equipment:** center partition, 2 height-adjustable shelves with drilled shelf assurance, plastic plinth panel with bottom-sided sealing lip.

Changes and errors reserved. Illustrations similar.