

Product Sheet

20.05.2024

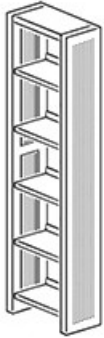

Model series	Lettore-Shelf
Description	Front-side shelf
Model	92186
ID	71410
Width/Depth/Height	60/30/183 cm
Weight	24.2 kg

one-sided bookcase with 5 adjustable book shelves and a cover shelf, designed in steel construction. Vertical frame parts of steel profiles 30/49 mm punched with rows of slots in a grid of 20 mm. Cross frame parts of steel profiles 18/71 mm. Left and right shelf frame with perforated sheet cover. Book shelves and cover shelf of multiple edged sheet steel, shelf thickness 32 mm, book stop bar, suitable for uptake hanging bookends and labeling elements. Metal components powder coated in RAL 9006 white aluminum. Front side mounted on double sided bookcase. GS (tested safety).

Changes and errors reserved. Illustrations similar.