

# Product Sheet

17.05.2024

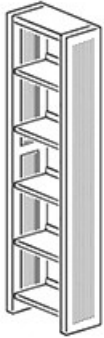

<b>Model series</b>	Lettore-Shelf
<b>Description</b>	Front-side shelf
<b>Model</b>	91186
<b>ID</b>	71285
<b>Width/Depth/Height</b>	60/30/183 cm
<b>Weight</b>	29.5 kg

one-sided bookcase with 5 adjustable book shelves a cover shelf, designed in wood and steel construction. Vertical frame parts of steel profiles 30/49 mm punched with rows of slots in a grid of 20 mm. Cross frame parts of steel profiles 18/71 mm. Left and right shelf frame with perforated sheet covering. Metal components are powder coated in RAL 9006 white aluminium. Book shelves and cover shelf of beech real wood veneered blockboard, 26 mm thick, varnished, profile-milled book stop bar of plywood, suitable for uptake of sliding bookends. Front side mounted on double sided bookcase.

Changes and errors reserved. Illustrations similar.