

Product Sheet

05.05.2024

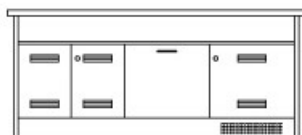

Model series

SciENZA-Master

Description

Teacher's experiment table

Model

1780 FK

ID

68523

Length/Width/Height

210/75/91 cm

Weight

214 kg

Dimensions: 210/75/91 cm, 120 cm long worktop of large-surface porcelain stoneware composite panel, stoneware format 60/60 cm or 90/60 cm, beaded-edge tiles, panel thickness 4 cm, 90 cm long worktop with 1 mm laminate coating, edging 5 mm, panel thickness 3 cm, on the left and right with profile cover panel 3/62/87 cm, at the corners of powder coated shaped tube 50/30/2 mm, base cupboards at the top with energy space, energy frame 20 cm high of powder coated sheet steel with removable installation panel, sight rear panel, plinth panels with bottom-sided sealing lip, below from left to right.

1 Base cupboard for water supply: 75/62/87 cm, 2 revolving doors with drilled stop damping, aperture angle 270°, hinges powder coated with automatic hold-closed function, cylinder locking device with olive handle, ventilation grille, 1 fitted shelf.

1 Base cupboard for teacher's experiment switchboard: 60/62/87 cm, 1 front panel for teacher's experiment switchboard with drilled stop damping, 1 metal bow handle.

1 Base cupboard for gas supply and electrical distributor: 60/62/87 cm, on the teacher side at the top an energy space, below a fixed intermediate shelf, 1 revolving door with drilled stop damping, aperture angle 270°, hinges powder coated with automatic hold-closed function, cylinder locking device with olive handle, ventilation grille, 1 fitted shelf, on the student side a niche for installation of an electrical distributor, fire-resistant corpus, 1 fire-resistant revolving door with drilled stop damping, aperture angle 100°, hinges with automatic hold-closed function, cylinder locking device with flush-mounded cylinder, ventilation grille in plinth panel.

Changes and errors reserved. Illustrations similar.