

Product Sheet

07.05.2024

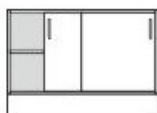

Model series	Armadio-Base
Description	Sliding door cupboard
Model	87200-S
ID	61402
Width/Depth/Height	150/43/73.5 cm
Weight	54 kg

2 sliding doors with metal bow handle and drilled stop damping, rotary push cylinder lock.

Equipment: center partition, 2 height-adjustable shelves with drilled shelf assurance, plastic plinth panel with bottom-sided sealing lip.

Changes and errors reserved. Illustrations similar.