

Product Sheet

03.05.2024

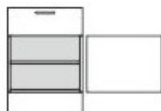

Model series	Armadio-Base
Description	Low cupboard
Model	85191-S
ID	61395
Width/Depth/Height	60/56/73.5 cm
Weight	40.8 kg

Equipment: above a metal apron drawer with railing, apron height 8.3 cm, full extensions with self-closing and drawer damping, lockable with flush-mounted cylinder, 1 metal bow handle, below a fixed intermediate shelf, 1 revolving door aperture angle 270°, hinges with automatic hold-closed function, cylinder locking device with olive handle, drawer panel and revolving door with drilled stop damping, 1 height-adjustable shelf with drilled shelf assurance, plastic plinth panel with bottom-sided sealing lip.

Changes and errors reserved. Illustrations similar.