

Product Sheet

08.05.2024

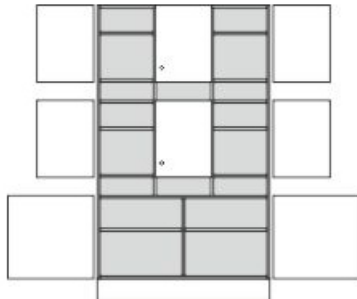

Model series

Armadio-Office

Description

Teachers compartment cupboard

Model

82390-S

ID

61519

Width/Depth/Height

120/45/205 cm

Weight

141 kg

for 6 teachers, with open shelves for post and lockable cupboard compartments.

Per cupboard compartment (at the top): 1 revolving door with drilled stop damping, aperture angle 270°, hinges with automatic hold-closed function, cylinder locking device with olive handle, different lockable, 1 height-adjustable shelf with drilled shelf assurance.

Cupboard compartment (at the bottom): 2 revolving doors with drilled stop damping, aperture angle 270°, hinges with automatic hold-closed function, cylinder locking device with olive handle, center partition, 2 height-adjustable shelves with drilled shelf assurance, plastic plinth panel with bottom-sided sealing lip.

Changes and errors reserved. Illustrations similar.