

Product Sheet

04.05.2024

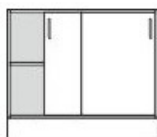

Model series	Armadio-Base
Description	Sliding door cupboard
Model	81205-S
ID	61405
Width/Depth/Height	105/43/90.5 cm
Weight	46.7 kg

2 sliding doors with metal bow handle and drilled stop damping, rotary push cylinder lock.

Equipment: center partition, 2 height-adjustable shelves with drilled shelf assurance, plastic plinth panel with bottom-sided sealing lip.

Changes and errors reserved. Illustrations similar.