

# Product Sheet

29.04.2024

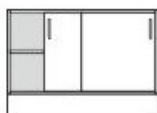

## Model series

Armadio-Base

## Description

Sliding door cupboard

## Model

81200-S

## ID

61400

## Width/Depth/Height

105/43/73.5 cm

## Weight

40.6 kg

2 sliding doors with metal bow handle and drilled stop damping, rotary push cylinder lock.

**Equipment:** center partition, 2 height-adjustable shelves with drilled shelf assurance, plastic plinth panel with bottom-sided sealing lip.

Changes and errors reserved. Illustrations similar.