

Product Sheet

02.05.2024

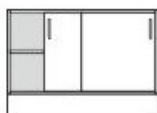

Model series	Armadio-Base
Description	Sliding door cupboard
Model	81200
ID	57803
Width/Depth/Height	105/43/73.5 cm
Weight	40.5 kg

2 sliding doors with metal bow handle and drilled stop damping.

Equipment: center partition, 2 height-adjustable shelves with drilled shelf assurance, plastic plinth panel with bottom-sided sealing lip.

Changes and errors reserved. Illustrations similar.