

Product Sheet

07.05.2024

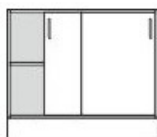

Model series

Armadio-Base

Description

Sliding door cupboard

Model

80205-S

ID

61404

Width/Depth/Height

90/43/90.5 cm

Weight

41.8 kg

2 sliding doors with metal bow handle and drilled stop damping, rotary push cylinder lock.

Equipment: center partition, 2 height-adjustable shelves with drilled shelf assurance, plastic plinth panel with bottom-sided sealing lip.

Changes and errors reserved. Illustrations similar.