

Product Sheet

28.04.2024

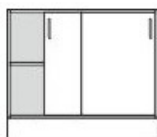

Model series	Armadio-Base
Description	Sliding door cupboard
Model	80205
ID	57806
Width/Depth/Height	90/43/90.5 cm
Weight	41.7 kg

2 sliding doors with metal bow handle and drilled stop damping.

Equipment: center partition, 2 height-adjustable shelves with drilled shelf assurance, plastic plinth panel with bottom-sided sealing lip.

Changes and errors reserved. Illustrations similar.