

Product Sheet

30.04.2024

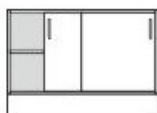

Model series	Armadio-Base
Description	Sliding door cupboard
Model	80200-S
ID	61399
Width/Depth/Height	90/43/73.5 cm
Weight	36.3 kg

2 sliding doors with metal bow handle and drilled stop damping, rotary push cylinder lock.

Equipment: center partition, 2 height-adjustable shelves with drilled shelf assurance, plastic plinth panel with bottom-sided sealing lip.

Changes and errors reserved. Illustrations similar.