

# Product Sheet

29.04.2024

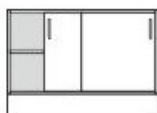

|                           |                       |
|---------------------------|-----------------------|
| <b>Model series</b>       | Armadio-Base          |
| <b>Description</b>        | Sliding door cupboard |
| <b>Model</b>              | 80200                 |
| <b>ID</b>                 | 57802                 |
| <b>Width/Depth/Height</b> | 90/43/73.5 cm         |
| <b>Weight</b>             | 36.2 kg               |

2 sliding doors with metal bow handle and drilled stop damping.

**Equipment:** center partition, 2 height-adjustable shelves with drilled shelf assurance, plastic plinth panel with bottom-sided sealing lip.

Changes and errors reserved. Illustrations similar.